

Abb 1a: Gehäuse DB

1004 820



Abb 2: Fahrwerk

1004 820

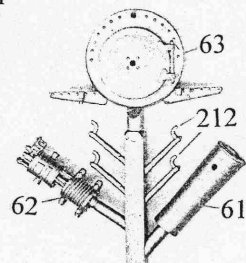
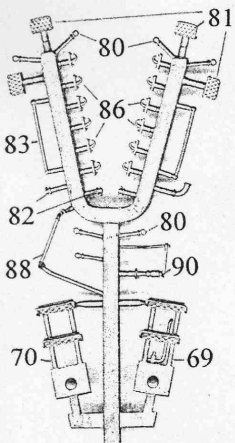
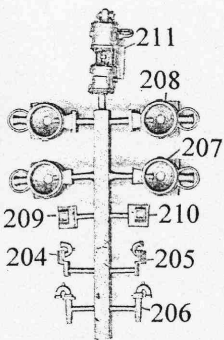
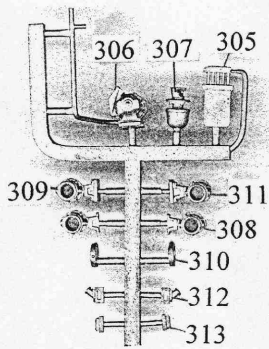
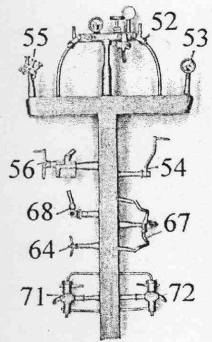
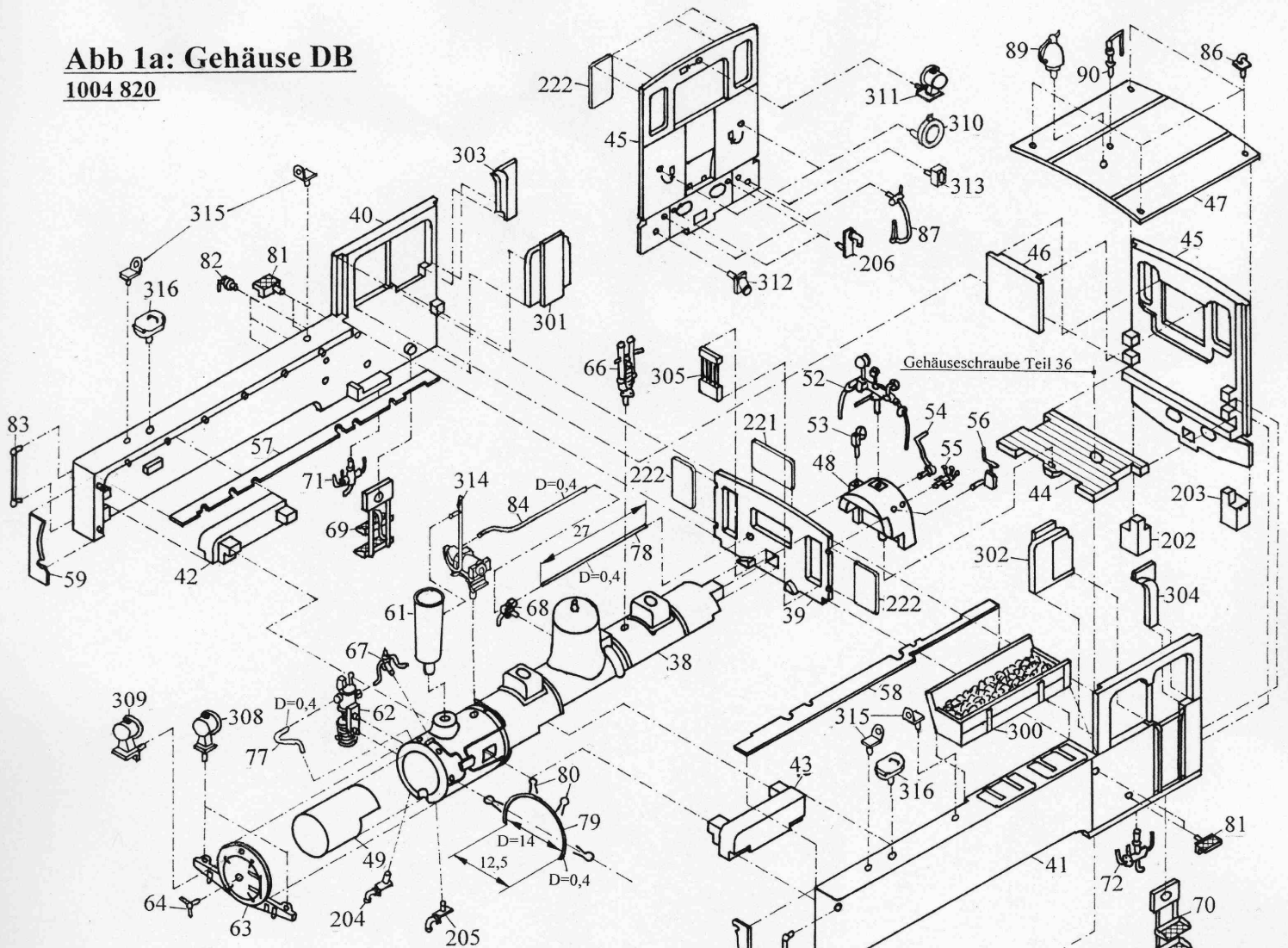

Abb 1b: Gehäuse DRG

1004 820

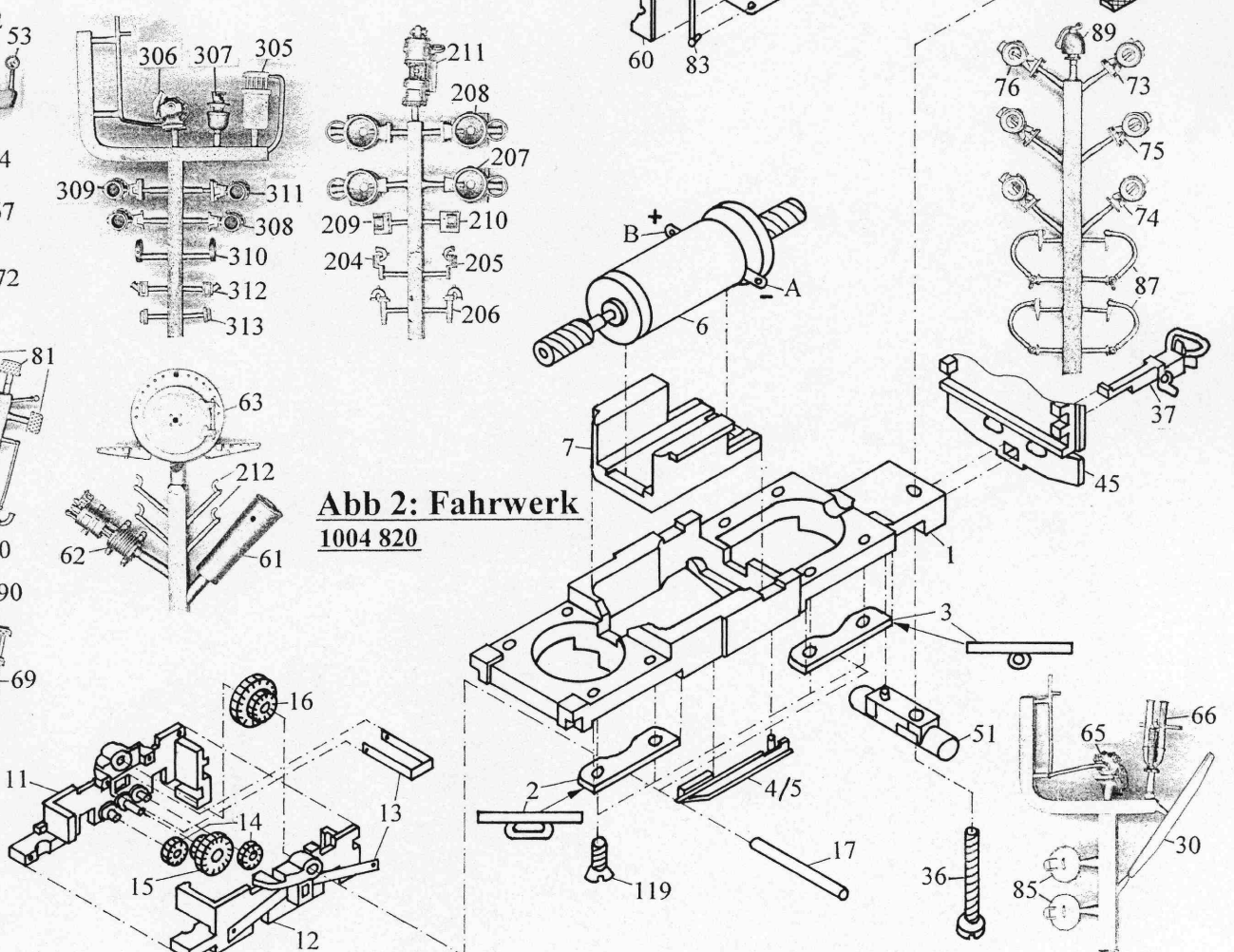

Abb 1c: Gehäuse Länderbahn

1004 820

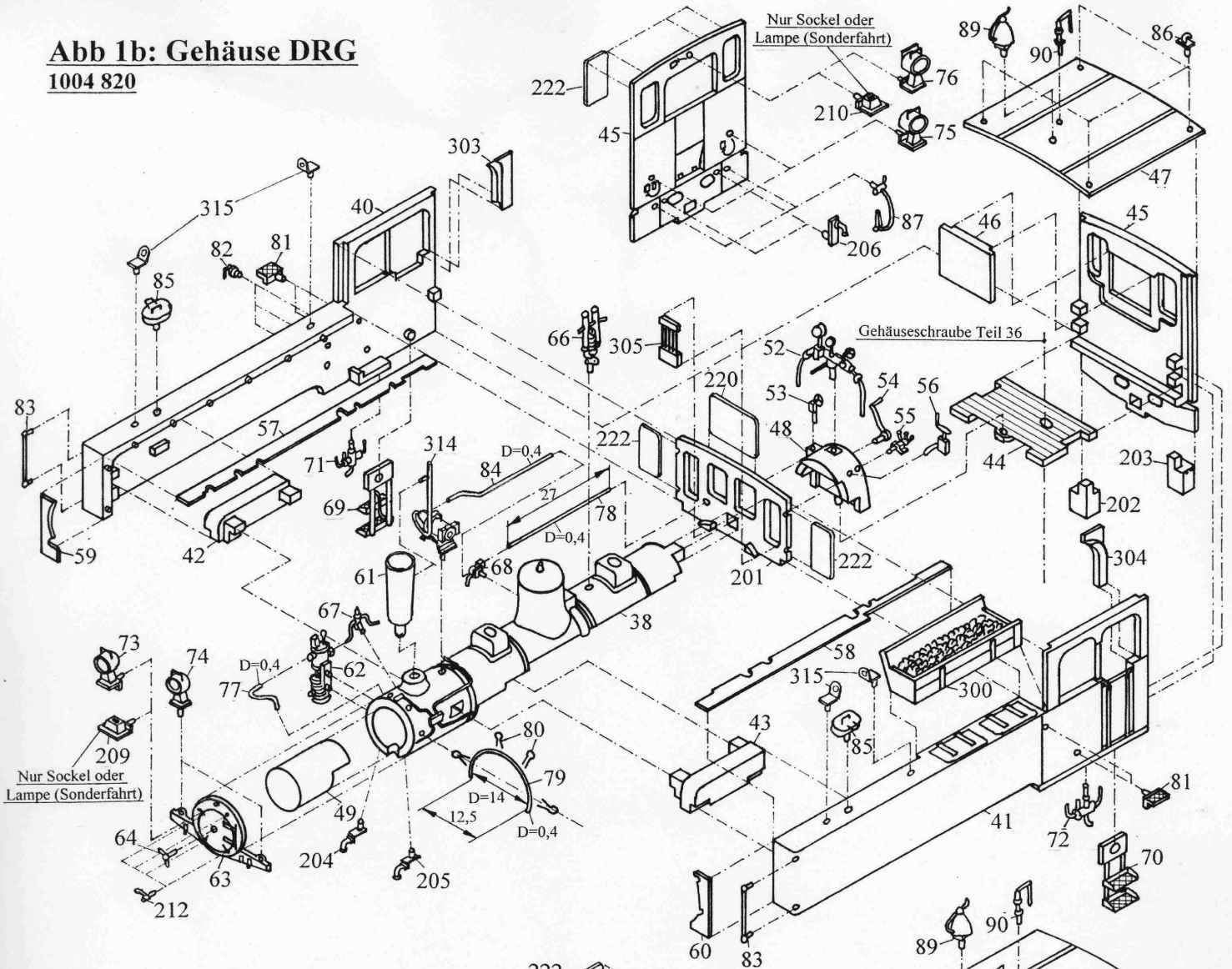

Abb 3: Triebwerk vorn, Steuerungsteile

1004 820

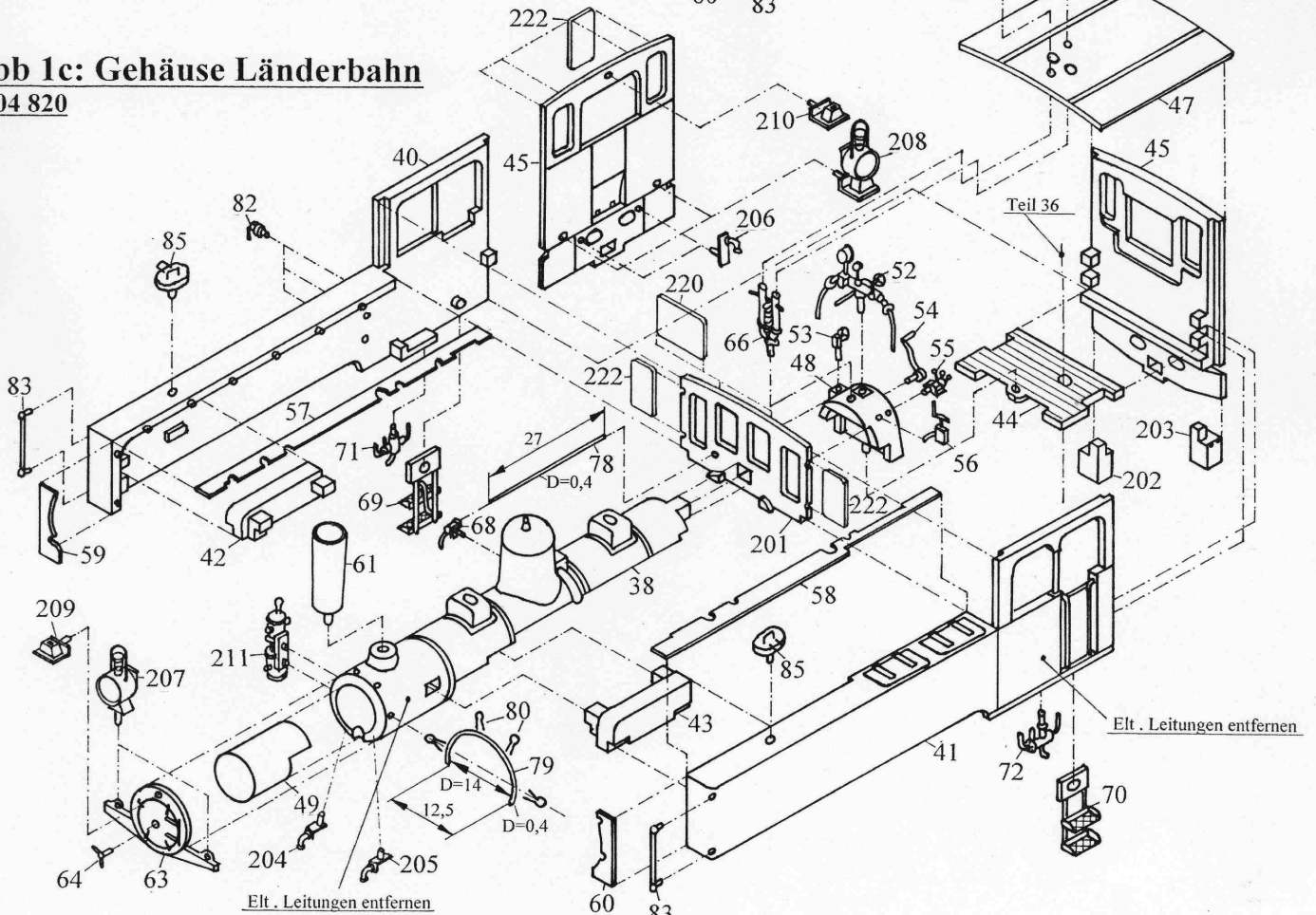

Abb 4: Triebwerk hinten

1004 820

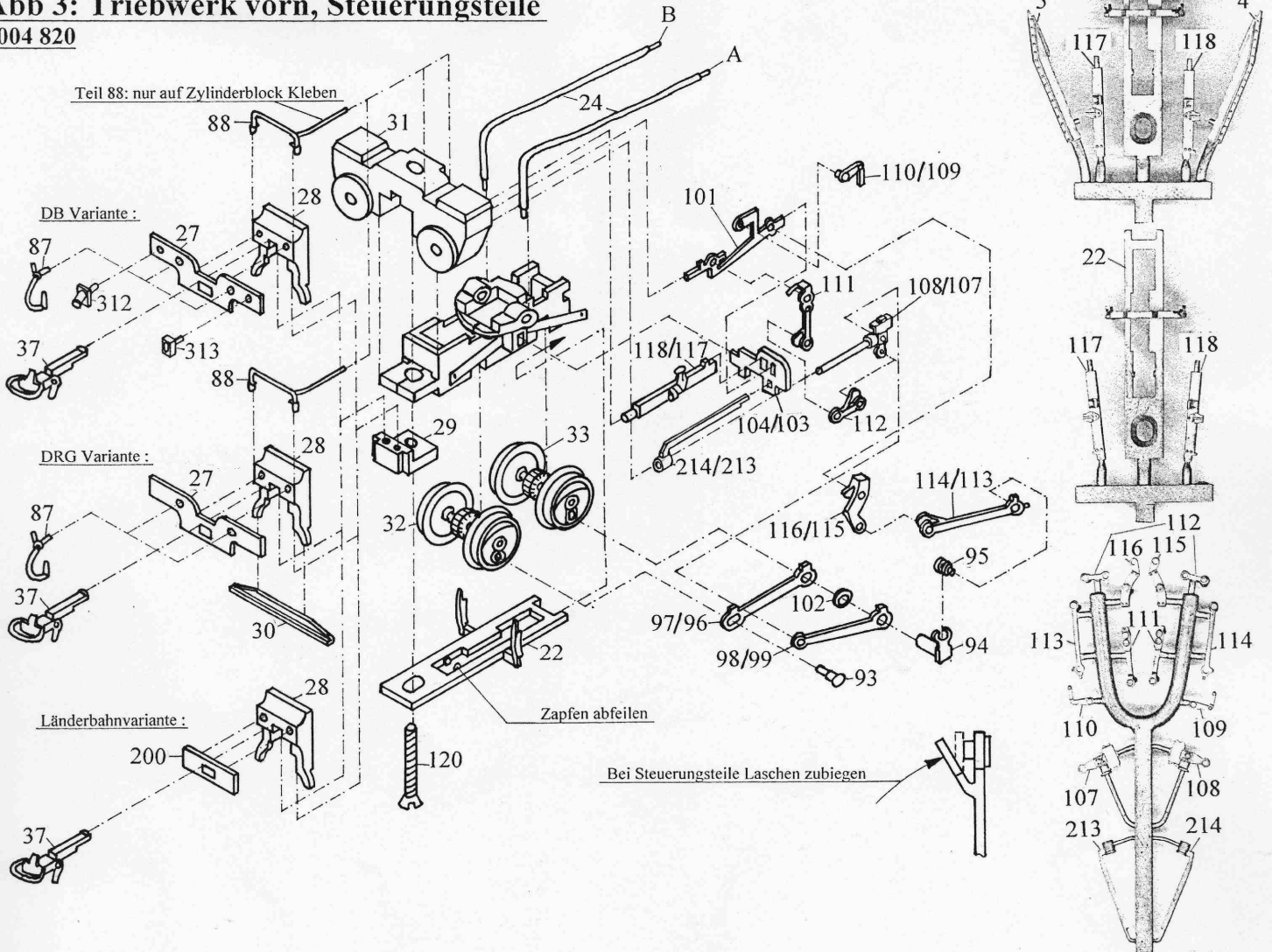